

For Amenity Grassland and Arable Field Margins		
SEEDING SCHEDULE		
Agrostis stolonifera	(Creeping Bent)	10
Alopecurus pratense	(Meadow Foxtail)	3
Anthoxanthum odoratum	(Sweet Vernal Grass)	3
Cynosaurus cristatus	(Crested Dogtail)	5
Dactylis glomerata	(Cock's Foot)	10
Festuca pratensis	(Meadow Fescue)	15
Festuca rubra ssp rubra	(Creeping Red Fescue)	15
Lolium perenne	(Perennial Ryegrass)	21
Pheum pratense	(Timothy)	10
Poa trivialis	(Rough Stalked meadow Grass)	3
Trifolium pratense	(Red Clover)	5
TOTAL		100

To be sown at 10g/m2

UK BIODIVERSITY ACTION PLAN HABITAT: Total Area (hectares):	
	Within Site
Ponds	0.3
Wet Woodland	0.7
Lowland Meadows	1.9
Arable Field Margins	2.5
Reedbeds	2.0
Hedgerow	(900 metres)
	7.4

PLANTING SCHEDULE			% Wet Woodland P1 and P2	% Hedgerows H1 and H2
TREES	Size	Notes		
Acer campestre	(Field Maple)	0.4-0.6m t/s		35
Alnus glutinosa	(Alder)	0.4-0.6m t/s	15	
Betula pubescens	(Downy Birch)	0.4-0.6m t/s	8	
Carpinus betulus	(Hornbeam)	0.4-0.6m t/s		25
Quercus robur	(Oak)	0.35-0.45m t/s		1
Salix alba	(Crack Willow)	0.4-0.6m t/s	25	
Salix fragilis	(White Willow)	0.4-0.6m t/s	20	
Tilia cordata	(Small Leaved Lime)	0.4-0.6m t/s	2	
TOTAL TREES			70	61
SHRUBS				
Cornus sanguinea	(Dogwood)	0.4-0.6m t/s	5	8
Corylus avellana	(Hazel)	0.4-0.6m t/s	5	25
Crataegus monogyna	(Hawthorn)	0.4-0.6m t/s		5
Prunus spinosa	(Blackthorn)	0.4-0.6m t/s		1
Salix caprea	(Goat Willow)	0.4-0.6m t/s	10	
Salix cinerea	(Salrow)	0.4-0.6m t/s	5	
Salix viminalis	(Osier)	0.4-0.6m t/s	5	
TOTAL SHRUBS			30	39
TOTAL TREES AND SHRUBS			100	100

Programme of Implementation
To be carried out in November-March planting season for bare root stock.
Prior to planting, any areas of compaction to be broken up to a depth of 450mm.
Transplant trees and shrubs to be notch planted.
Tree feathered stock to be pit planted, with backfill 1 part peat free compost to 3 parts soil

Maintenance
All planting to be maintained by use of glyphosate to create a 1.0m diameter circle around each tree and shrub during the five year aftercare period, or until canopies close. This will permit rapid establishment.
All to be protected with "Tubex" tree shelters
Two maintenance visits will be carried out per year during the aftercare period, one in spring and one in early summer.
Visits will include weed control (including noxious w weeds), litter removal and checking and firming up tree shelters.
Any plants dying during the five-year aftercare period will be replaced with a size and species to be agreed with the Mineral Planning Authority to maintain 100% stocking rate during the aftercare period and to achieve a minimum 90% stocking rate upon final restoration.
Any plants loosened by frost or wind will be firmed up and any damaged branches will be removed using a sharp pruning knife.
Tree shelters will be removed from the planting, should plant growth warrant it during the development.

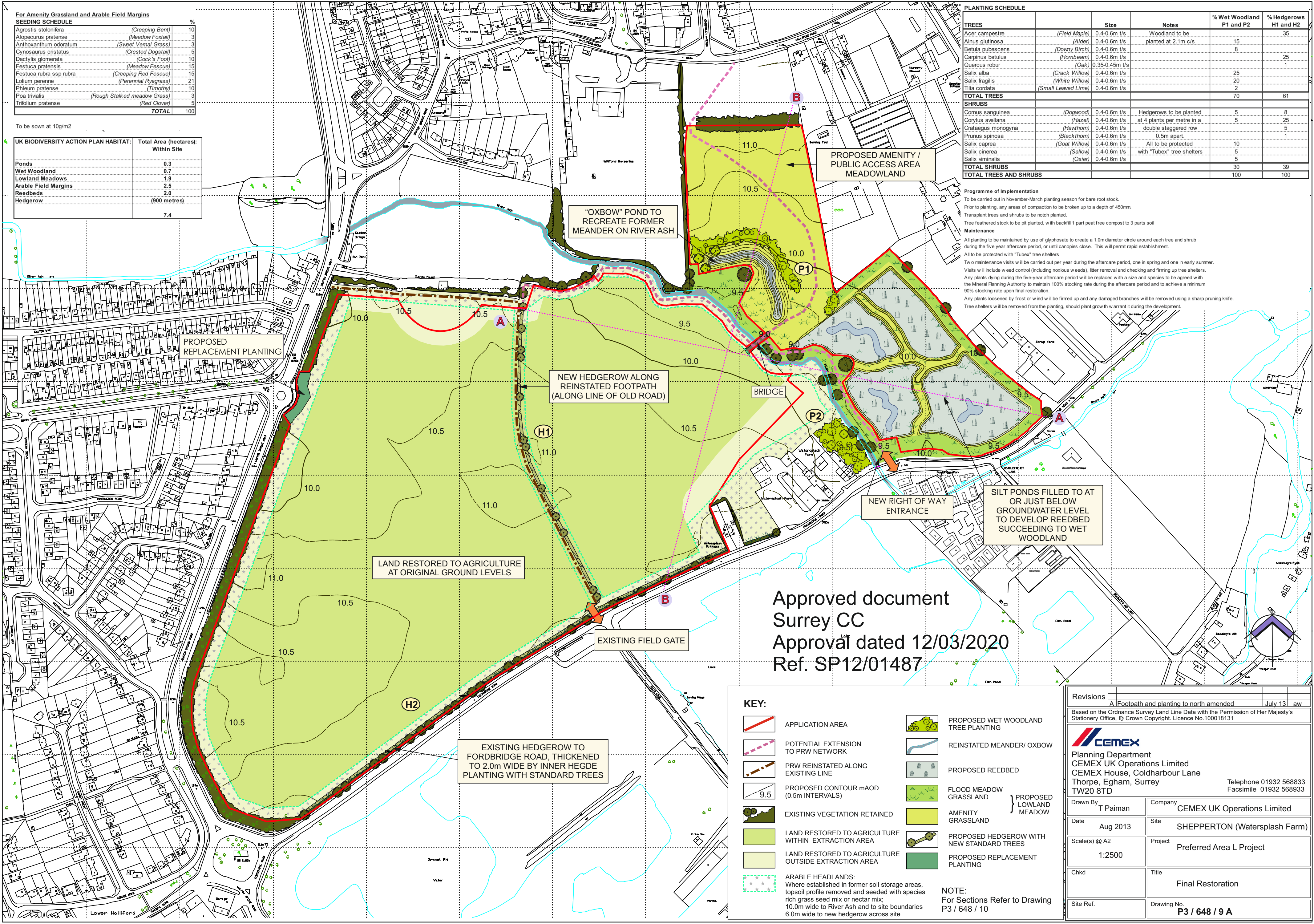

Approved document
Surrey CC
Approval dated 12/03/2020
Ref. SP12/01487

KEY:

	APPLICATION AREA		PROPOSED WET WOODLAND TREE PLANTING
	POTENTIAL EXTENSION TO PRW NETWORK		REINSTATED MEANDER/ OXBOW
	PRW REINSTATED ALONG EXISTING LINE		PROPOSED REEDBED
	PROPOSED CONTOUR mAOD (0.5m INTERVALS)		FLOOD MEADOW GRASSLAND
	EXISTING VEGETATION RETAINED		AMENITY GRASSLAND
	LAND RESTORED TO AGRICULTURE WITHIN EXTRACTION AREA		PROPOSED HEDGEROW WITH NEW STANDARD TREES
	LAND RESTORED TO AGRICULTURE OUTSIDE EXTRACTION AREA		PROPOSED REPLACEMENT PLANTING
	ARABLE HEADLANDS: Where established in former soil storage areas, topsoil profile removed and seeded with species rich grass seed mix or nectar mix; 10.0m wide to River Ash and to site boundaries 6.0m wide to new hedgerow across site		

NOTE:
For Sections Refer to Drawing P3 / 648 / 10

Revisions			
A Footpath and planting to north amended		July 13	aw
Based on the Ordnance Survey Land Line Data with the Permission of Her Majesty's Stationary Office, 11 Crown Copyright. Licence No.100018131			
 Planning Department CEMEX UK Operations Limited CEMEX House, Coldharbour Lane Thorpe, Egham, Surrey TW20 8TD Telephone 01932 568833 Facsimile 01932 568933			
Drawn By	T Paiman	Company	CEMEX UK Operations Limited
Date	Aug 2013	Site	SHEPPERTON (Watersplash Farm)
Scale(s) @ A2	1:2500	Project	Preferred Area L Project
Chkd		Title	Final Restoration
Site Ref.		Drawing No.	P3 / 648 / 9 A